

RevNo	Revision note	Date	Signature	Checked
A	DRAWING RELEASE	06 MAR 09	PN	JC

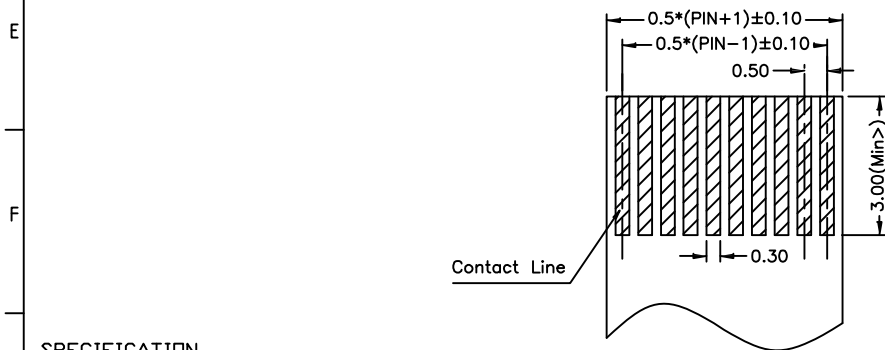
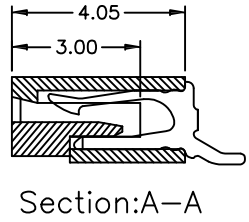
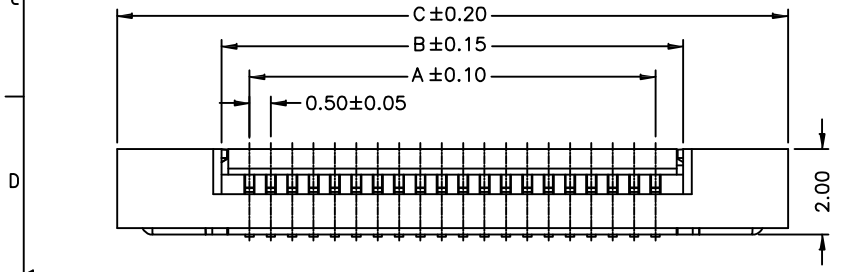
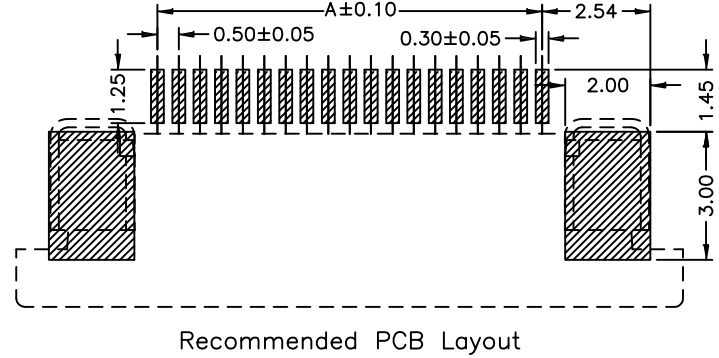
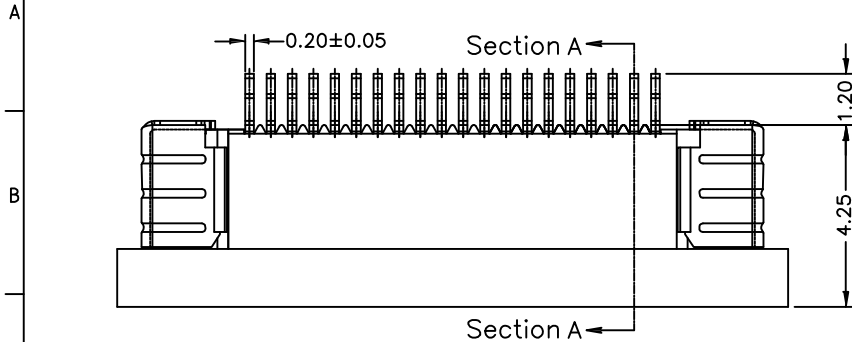

Thickness: 0.30±0.03
FPC Dimension Reference

Dimension:

PIN NO	A	B	C
4	1.50	2.60	7.70
5	2.00	3.10	8.20
6	2.50	3.60	8.70
7	3.00	4.10	9.20
8	3.50	4.60	9.70
9	4.00	5.10	10.20
10	4.50	5.60	10.70
11	5.00	6.10	11.20
12	5.50	6.60	11.70
13	6.00	7.10	12.20
14	6.50	7.60	12.70
15	7.00	8.10	13.20
16	7.50	8.60	13.70
17	8.00	9.10	14.20
18	8.50	9.60	14.70
19	9.00	10.10	15.20
20	9.50	10.60	15.70
21	10.00	11.10	16.20
22	10.50	11.60	16.70
23	11.00	12.10	17.20
24	11.50	12.60	17.70
25	12.00	13.10	18.20
26	12.50	13.60	18.70
27	13.00	14.10	19.20
28	13.50	14.60	19.70
29	14.00	15.10	20.20
30	14.50	15.60	20.70
31	15.00	16.10	21.20
32	15.50	16.60	21.70
33	16.00	17.10	22.20
34	16.50	17.60	22.70
35	17.00	18.10	23.20
36	17.50	18.60	23.70
37	18.00	19.10	24.20
38	18.50	19.60	24.70
39	19.00	20.10	25.20
40	19.50	20.60	25.70
41	20.00	21.10	26.20
42	20.50	21.60	26.70
43	21.00	22.10	27.20
44	21.50	22.60	27.70
45	22.00	23.10	28.20
46	22.50	23.60	28.70
47	23.00	24.10	29.20
48	23.50	24.60	29.70
49	24.00	25.10	30.20
50	24.50	25.60	30.70

* - TOOLED PARTS
(PLEASE CONTACT IMPERIAL FOR NON-TOOLED PARTS)

SPECIFICATION

CURRENT RATING: 0.5A
VOLTAGE RATING: 50V DC
CONTACT RESISTANCE: 20m OHM MAX.
INSULATOR RESISTANCE: 50M OHM MIN.
WITHSTANDING VOLTAGE: 500V AC FOR ONE MINUTE
OPERATING TEMPERATURE RANGE: -25°C ~ +85°C

MATERIAL:
INSULATOR: HIGH TEMP PLASTIC (NYLON 46 UL94V-0)
INSULATOR COLOUR: WHITE
CONTACT: PHOSPHOR BRONZE
PLATING: MATT TIN (LEAD FREE)
PACKING: 1500 PCS/REEL

ORDERING INFORMATION

05N12 - XXZ - OFN

NO. OF CONTACTS
04 TO 50

0.0 ± 0.2
0.00 ± 0.15

TOLERANCES UNLESS OTHERWISE NOTED
THIRD ANGLE PROJECTION



Drawn by: PN
Date: 06 MAR 09
Scale: NTS
Material: SEE NOTE
Revision: A
Part Number: 05N12
imperial
www.imperial-connect.com

0.5mm FPC CONNECTOR
TOP CONTACT TYPE, SIDE ENTRY
© THIS DRAWING IS CONFIDENTIAL AND MUST NOT BE COPIED OR DISCLOSED WITHOUT WRITTEN CONSENT
E and OE Sheet 1/1